

WEILER[®]
Food Processing Systems

DOMINATOR[™]

14 SF

SELF-FEEDING GRINDER



*Note: Safety labels removed for clarity.
All guards and labels must be in place while operating.*

A self-feeding grinder designed with advanced innovative features able to deliver higher productivity as well as improved product texture. Designed specifically for fresh meat final grind applications.

- Engineered to provide a ***Balanced Flow*** of product.
 - Improved product texture
 - More consistent particle definition and dimension
 - Higher productivity
 - Improved hard tissue and bone removal
- User friendly assembly and disassembly.
- Reduced operating costs.
- Increased life expectancy of gearbox and feedscrew splines.

DOMINATOR™ 14 SF

SPECIFICATIONS:

- **GRINDER DRIVE:** 100 HP (75 kw).
- **HOPPER SIZE:** 15 cubic foot (425 liter).
- **SELF-FEEDING PADDLE SYSTEM:** with 1.5 HP (1.1 kw) motor.
- **CONSTRUCTION:** 304 stainless steel, except for ring (tinned).
- **SCREW:** 9" (229 mm) diameter.
- **KNIFEHOLDER:** 3 or 6 blade available.
- **WEIGHT (Approx.):** Unskidded: 5700 lbs. (2586 kg); Skidded: 5950 lbs. (2699 kg).
- **GRINDER PLATE SIZE:** 14" (356 mm) diameter. Plate hole sizes available from 3/32" (2.4 mm) to 2" (50 mm) and larger.
- **GRIND RATE*:** up to 600 lbs./min. (272 kg./min.); 36,000 lbs./hr. (16,320 kg./hr.)

* Actual grind rate will depend on plate hole size, raw material, temperature, and feeding method.

DIMENSIONS:

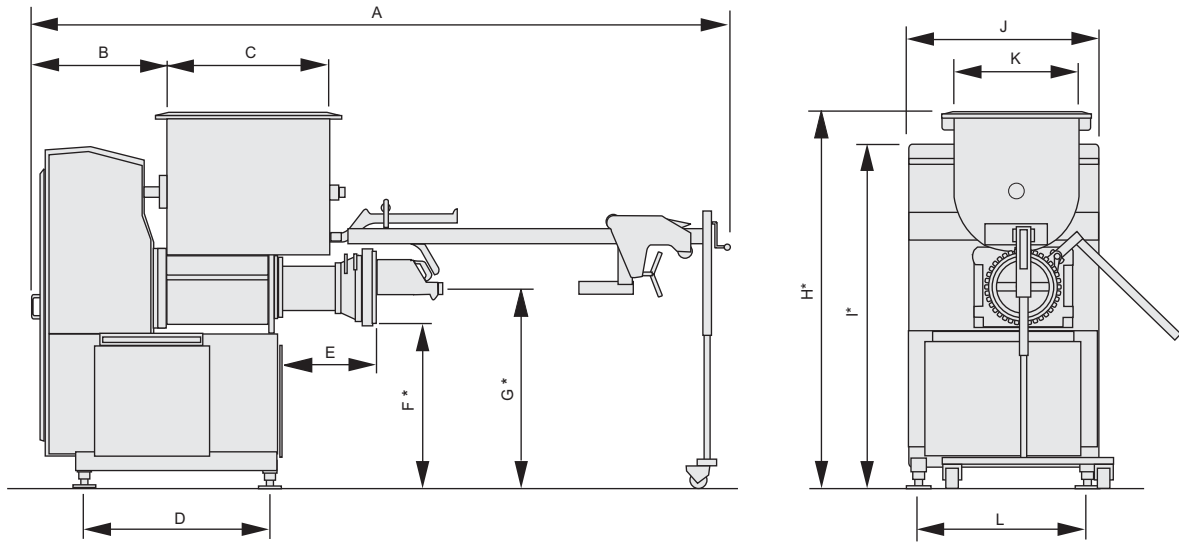

A	B	C	D	E	F*	G*	H*	I*	J	K	L
168	32	39	44	23	39	48	90	83	46	30	41
(4267)	(813)	(991)	(1118)	(584)	(991)	(1219)	(2286)	(2108)	(1168)	(762)	(1041)

Dimensions shown are rounded in inches (mm).
 * Up to 3" (76 mm) height adjustment.
 Dimensions and specifications subject to change without notice.

Note: Dimensions shown should not be used for installation purposes. Please request a certified approval drawing from Weiler.

WEILER® and Company, Inc.

www.weilerinc.com email: sales@weilerinc.com
 Corporate Headquarters: Whitewater, Wisconsin U.S.A.

USA: 262-473-5254 • 800-558-9507 • Fax: 262-473-5867 • Europe: +44 (0) 1454 320900 • Fax: +44 (0) 1454 326262

Grinders • Mixers • Conveyors • Mixer Grinders • Separators • Complete Systems